

# Sharpsmart Mounting SOP

Daniels Sharpsmarts have been designed with a dovetail slot in the rear of the container designed to seamlessly glide and lock into place when mounted on a Daniels wall bracket. **When mounting and removing a container, make sure the container is being lowered (for mounting) or lifted (for removing) in a vertical position.**

## How to **safely position** a Sharpsmart container on a Daniels wall bracket

- ▶ Line up the bottom of your Sharpsmart container with the bottom of the bracket.
- ▶ Flip the Sharpsmart container up (so the container is upright) and slide down onto the bracket.

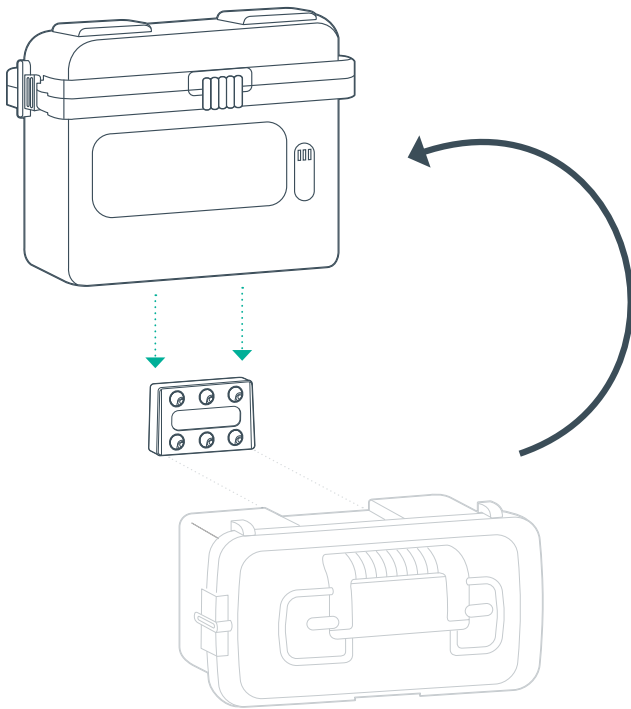

## How to **safely remove** a Sharpsmart container from a Daniels wall bracket

- ▶ Lift Sharpsmart container vertically until it is removed from the bracket

