

Be Sharpsmart

Keep your safety in check with these 4 easy-to-remember instructions.



1

Never put your hands into a collector



2

Never put sharps into normal waste bags or bins



3

Never place general waste into a collector

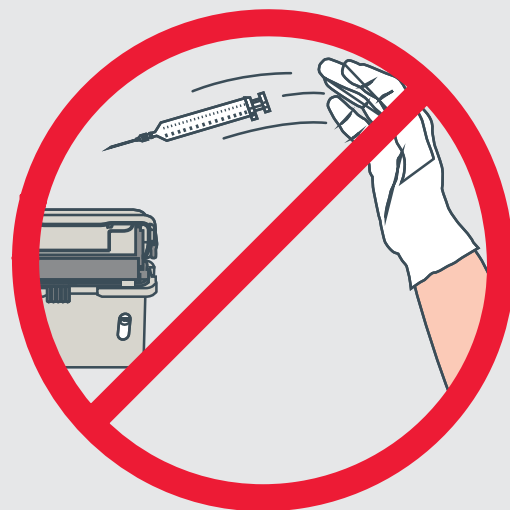

4

Never throw sharps into a collector

Sharpsmart

ACCESS PLUS | INSTRUCTIONS FOR USE

TO OPEN

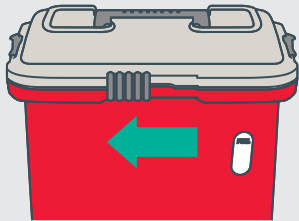

1 Slide the front lock to the left

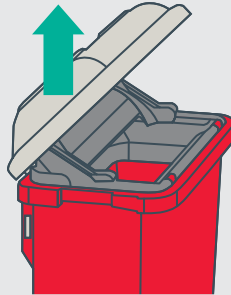

2 Lift lid to 45 degrees for semi-access opening

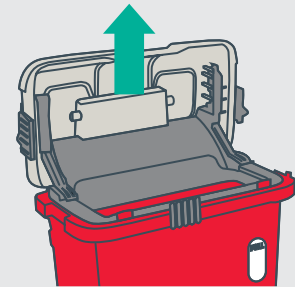

3 Lift lid to 90° for full access opening

USAGE

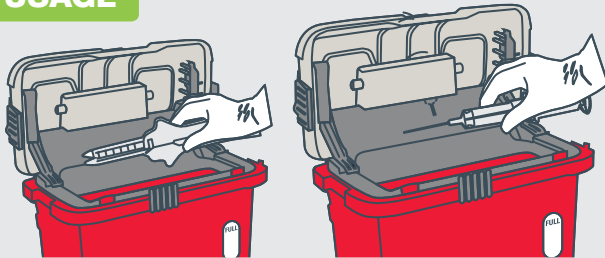

Drop items pointing downwards into opening

FULL

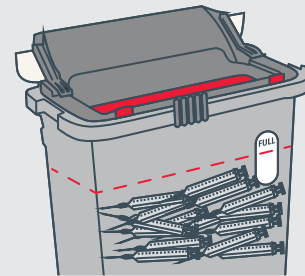

When sharps reach fill level, Access Plus collector is full and must be locked and replaced.

CLOSE

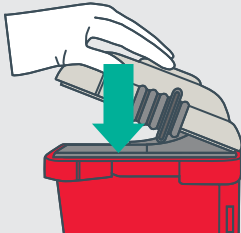

1 Press lid down firmly.

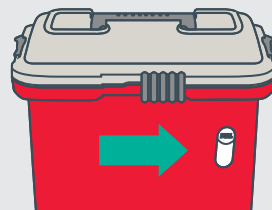

2 Slide the front lock fully to the right.

LOCK

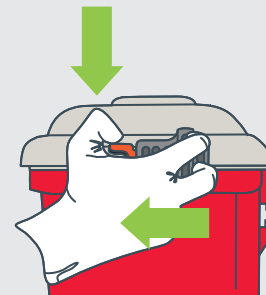

1 Depress red tabs.

2 Slide locks completely forward.

PLEASE NOTE
Side locks are permanent!

Remember

Never put your hands into a sharps collector.
Always close the collector before moving or removing container.
Do not deface or write on the collector.
Always dispose of sharps and sharps safety devices into sharps collectors.

Sharpsmart

REGULAR | INSTRUCTIONS FOR USE

OPEN

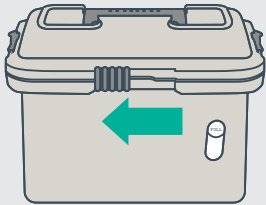

- 1 Slide the front lock to the left.

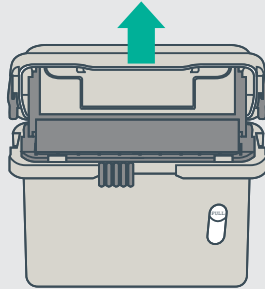

- 2 Lift lid until it locks open.

SYRINGES

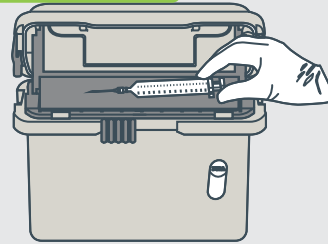

- 1 Drop syringes horizontally onto tray.

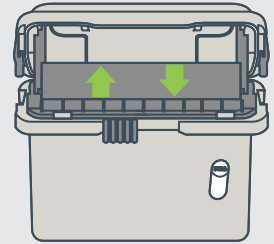

- 2 Tray will empty itself.

LIGHT SHARPS

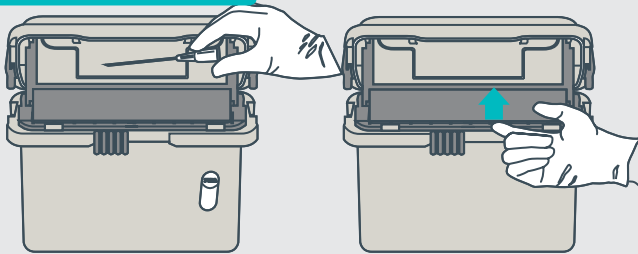

- 1 Drop sharp horizontally onto tray.
- 2 Manually lift the tray to empty.

FULL

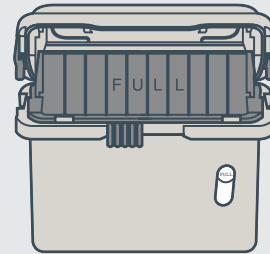

When the tray remains vertical, lock & replace the collector.

CLOSE

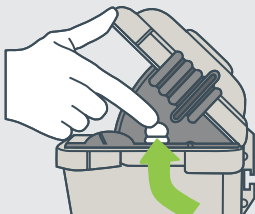

- 1 Press both side supports inward, close lid.

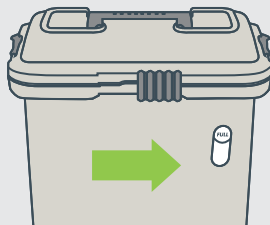

- 2 Slide the front lock fully to the right.

LOCK

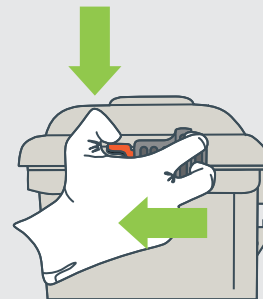

- 1 Depress red tabs.

- 2 Slide locks completely forward.

PLEASE NOTE
Side locks are permanent!

Remember

Never put your hands into a sharps collector.
Always close the collector before moving or removing container.
Do not deface or write on the collector.
Always dispose of sharps and sharps safety devices into sharps collectors.